

CONSTRUCTION OF 3BHK HOUSING PROJECT (MIG) AT SY.NO.95 OF
KANMINEKE PHASE IV, KENGERI HOBLI, BENGALURU.

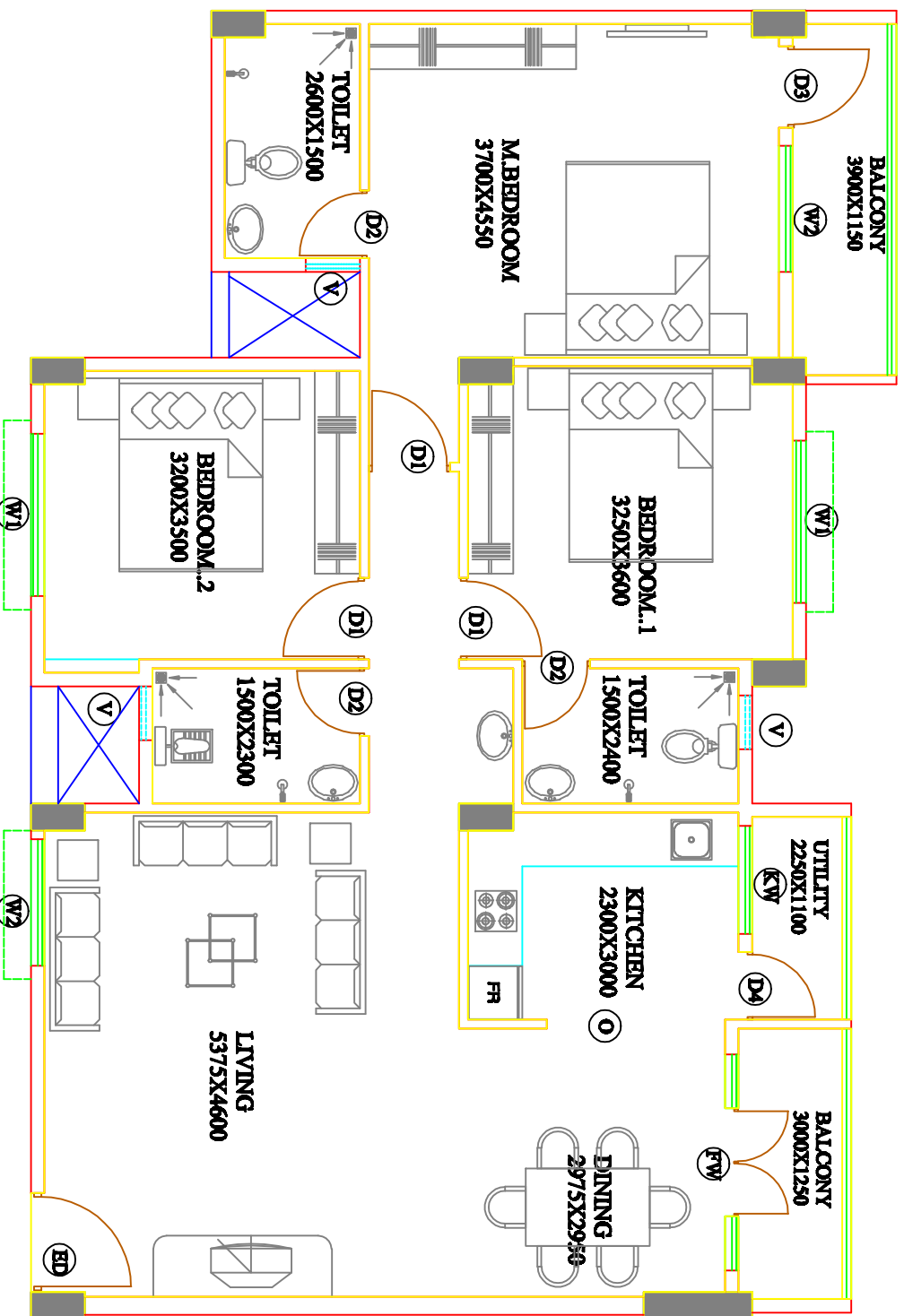

TYPICAL UNIT PLAN

SCHEDULE OF OPENINGS

TYPE	DESCRIPTION	SIZE
ED	ENTRANCE DOOR	1800 X 2100
FW	FRONT WINDOW	3600 X 2800
D	DOOR	1400 X 2600
D1	DOOR	800 X 2100
D2	DOOR	700 X 2600
D3	DOOR (Kitchen opening)	800 X 2600
D4	DOOR (Living opening)	700 X 2100
Q	OPENING	5000 X 2100
W	WINDOW	2600 X 1800 (Balcony)
W1	WINDOW	1400 X 1500
W2	WINDOW	1400 X 1500
KW	KITCHEN WINDOW	1500 X 600
V	VENTILATOR	600 X 600

NOTE: TYPICAL GENERAL CHALK/PEN PROJECTION

UNIT AREA CALCULATION

CLIENT: CANARA BHK (PVT) LTD
 PROJECT: MIG AT SY.NO.95 OF KANMINEKE PHASE IV, KENGERI HOBLI, BENGALURU
 DRAWN BY: ARCHITECT
 DATE: 15/08/2024

ROOM	AREA (Sq. Ft.)	PERIMETER (Sq. Ft.)
LIVING	5375 X 4660	24,770 Sq. Ft.
DINING	2975 X 2950	8,778 Sq. Ft.
KITCHEN	2300 X 3000	6,900 Sq. Ft.
UTILITY	2250 X 1100	2,475 Sq. Ft.
BALCONY	3000 X 1250	3,750 Sq. Ft.
BED ROOM.1	3250 X 3660	11,900 Sq. Ft.
BED ROOM.2	3200 X 3500	11,200 Sq. Ft.
M.BED ROOM	3700 X 4550	16,825 Sq. Ft.
TOILET	1500 X 2300	3,450 Sq. Ft.
TOILET	2600 X 1500	3,900 Sq. Ft.
BATH	1500 X 1500	2,250 Sq. Ft.
TERRACE	2600 X 1150	2,990 Sq. Ft.
TOTAL	150,000 Sq. Ft.	620,000 Sq. Ft.



ASHTAKA ENGINEERING & ARCHITECTURE
 10/1, KENGERI HOBLI, BENGALURU
 CONTACT: 98454 44444

Ashtaka Engineering & Architecture
 10/1, KENGERI HOBLI, BENGALURU
 CONTACT: 98454 44444

CONSTRUCTION OF 3BHK HOUSING PROJECT AT SY.NO.95 OF KANMINEKE PHASE IV, KENGERI HOBLI, BENGALURU. DRAWN BY: ARCHITECT. DATE: 15/08/2024.

TYPICAL UNIT PLAN